

IMPORTANT CONFERENCE INFORMATION

(download and print)

16th International Conference on Computational and Financial Econometrics (CFE 2022)

<http://www.cfenetwork.org/CFE2022>

and

15th International Conference of the ERCIM (European Research Consortium for Informatics and Mathematics) Working Group on Computational and Methodological Statistics (CMStatistics 2022)

<http://www.cmstatistics.org/CMStatistics2022>

King's College London, UK

17 – 19 December 2022



SCHEDULE (GMT)

2022-12-17	2022-12-18	2022-12-19
A - Keynote CFE - CMStatistics 08:30 - 09:30	G CFE - CMStatistics 08:15 - 09:55	L CFE - CMStatistics 08:40 - 09:55
Coffee Break 09:30 - 10:00	Coffee Break 09:55 - 10:25	Coffee Break 09:55 - 10:25
C CFE - CMStatistics 10:00 - 12:05	H CFE - CMStatistics 10:25 - 12:05	M CFE - CMStatistics 10:25 - 12:05
Lunch Break 12:05 - 13:35	Lunch Break 12:05 - 13:35	Lunch Break 12:05 - 13:35
D CFE - CMStatistics 13:35 - 15:40	I CFE - CMStatistics 13:35 - 15:15	N - Keynote CFE - CMStatistics 13:35 - 14:25
Coffee Break 15:40 - 16:10	Coffee Break 15:15 - 15:45	
E CFE - CMStatistics 16:10 - 17:50	J CFE - CMStatistics 15:45 - 17:00	P CFE - CMStatistics 14:40 - 16:20
		Coffee Break 16:20 - 16:50
F CFE - CMStatistics 18:05 - 19:20	K CFE - CMStatistics 17:15 - 19:20	Q CFE - CMStatistics 16:50 - 18:30
Welcome reception 19:30 - 21:00	Christmas Conference Dinner 20:00 - 22:30	R - Keynote CFE - CMStatistics 18:45 - 19:40

TUTORIALS, MEETINGS AND CONFERENCE DETAILS (see maps)

TUTORIALS

Tutorials will take place on Friday the 16th of December 2022, at the Council Room, Strand building. The first tutorial ("Extreme Value Analysis") will be delivered by Prof. Armelle Guillou, University of Strasbourg, France, 9:00-13:30 (GMT). The second tutorial ("Latent variable dynamic model") will be delivered by Prof. Michael Pitt, King's College London, UK, 15:00 to 19:30 (GMT). Only participants who had subscribed for the tutorial can attend, either in person or virtually through the website.

SPECIAL MEETINGS

The *Econometrics and Statistics (EcoSta) Editorial Board* and the *CSDA and Annals of Statistical Data Science Editorial Board* meetings will take place on Friday the 16th of December 2022, 17:45-18:30 (GMT). Indications to attend the Editorial Board meetings will be sent to the AEs attending the conference in due course.

CONFERENCE DETAILS

Access

- All the participants can attend virtually or in person. However, the in-person access to King's College London is restricted to those who had confirmed their in-person participation during the registration.
- The in-person venue is King's College London, Strand campus (Strand, London WC2R 2LS, United Kingdom).
- Indication to access the virtual part of the conference can be found on the webpage.
- The registration will be open on Friday afternoon, from 14:00 to 19:00, during the weekend from 7:30 to 18:00 and on Monday from 8:00 to 16:30 in the Arcade of the Bush House - Central Block (ground floor).

Scientific programme and social events

- The conference is live streaming, and it will not be recorded. The virtual oral presentations will take place through Zoom, while the social events and poster presentations will run in Gather Town.
- **Scientific programme:** The virtual and hybrid sessions are accessible from the interactive schedule. The conference programme time is set in GMT. Indications to access the in-person and virtual rooms can be found on the website. The in-person participants can use BH (S) 2.01, BH (SE) 2.01, S-2.08 and S-1.08 as quiet rooms and to participate in virtual sessions with their laptops and headphones.
- **Coffee breaks:** The coffee breaks will last 40 minutes each (beginning 10 minutes before the times indicated in the program). These will take place at the Great Hall of the King's Building (ground floor) and the Arcade of the Bush House - Central Block (ground floor). You must have your conference badge in order to attend the coffee breaks.
- **Lunches:** Sandwich box lunches have been organized for the three days of the conference. The lunches will take place at the Great Hall of the King's Building (Ground Floor). The lunches are optional, and registration is required. Participants must bring their conference badge to attend the lunches. Information about the purchased lunches is embedded in the QR code on the conference badge. During lunchtime each day, the conference participants are invited to interact in the conference virtual networking space. Indications to access the networking space can be found on the website.
- **Welcome reception:** The in-person welcome reception for registered participants will take place at the Great Hall of the King's building (Ground floor) and the Arcade of Bush House (Ground floor) on Saturday the 17th of December 2022 from 19:30 to 21:00 (GMT). Participants must bring their conference badge to attend the reception. Information about the welcome reception booking is embedded in the QR code on the conference badge. Simultaneously, a virtual welcome reception will take place in Gather Town. Indications to access the can be found on the website.
- **Christmas Conference Dinner:** The Christmas Conference Dinner will take place on Sunday the 18th of December 2022, at 20:00 at the Ambassadors Bloomsbury Hotel (12 Upper Woburn Pl, London WC1H 0HX). The conference dinner is optional, and registration is required. Participants must bring their conference badge to attend the conference dinner. Information about the purchased conference dinner ticket is embedded in the QR code on the conference badge.

Presentation instructions

The virtual presentations will take place through Zoom. Speakers should install the application, have a stable internet connection, and ensure their video and audio work. They will share their slides when the chair requires it, present their talk, and answer the question after the presentation. The in-person speakers must copy their presentations on the desktop on the conference room PCs and then share them on Zoom. The PCs have a touch screen with a webcam, a mobile support and an omnidirectional desk microphone that collects the sound around the PC desk to make the live streaming easy. Detailed indications for speakers in either virtual or hybrid sessions can be found on the website. As a general rule, each speaker has 20 minutes for the talk and 3-4 minutes for discussion. Strict timing must be observed.

Posters

The poster sessions will take place through Gather Town. The posters should be sent in **png format** to info@CMStatistics.org by the 14th of December. Landscape orientation is advisable. Detailed indications for the poster presentations can be found on the website.

Session chairs

The session chairs will be responsible for introducing the session, the speakers and coordinating the discussion time. A member of the conference staff, identified on Zoom by the name Angel, will assist online. If any speaker is missing or has a technical problem, the chair can pass to the next speaker and come back later to resume if possible. Detailed indications for the session chairs of both virtual and hybrid sessions can be found on the website.

Test session

A test session will be set up for Saturday the 10th of December 2022 from 14:00 to 14:30 GMT. The participants will be able to enter virtually the hybrid room BH (S) 1.01 Lecture Theatre from the interactive programme to test their presentations, video, micro and audio (e.g., through the Slot C). Detailed indications for the test sessions can be found on the website.

Maps of the venue and nearby area

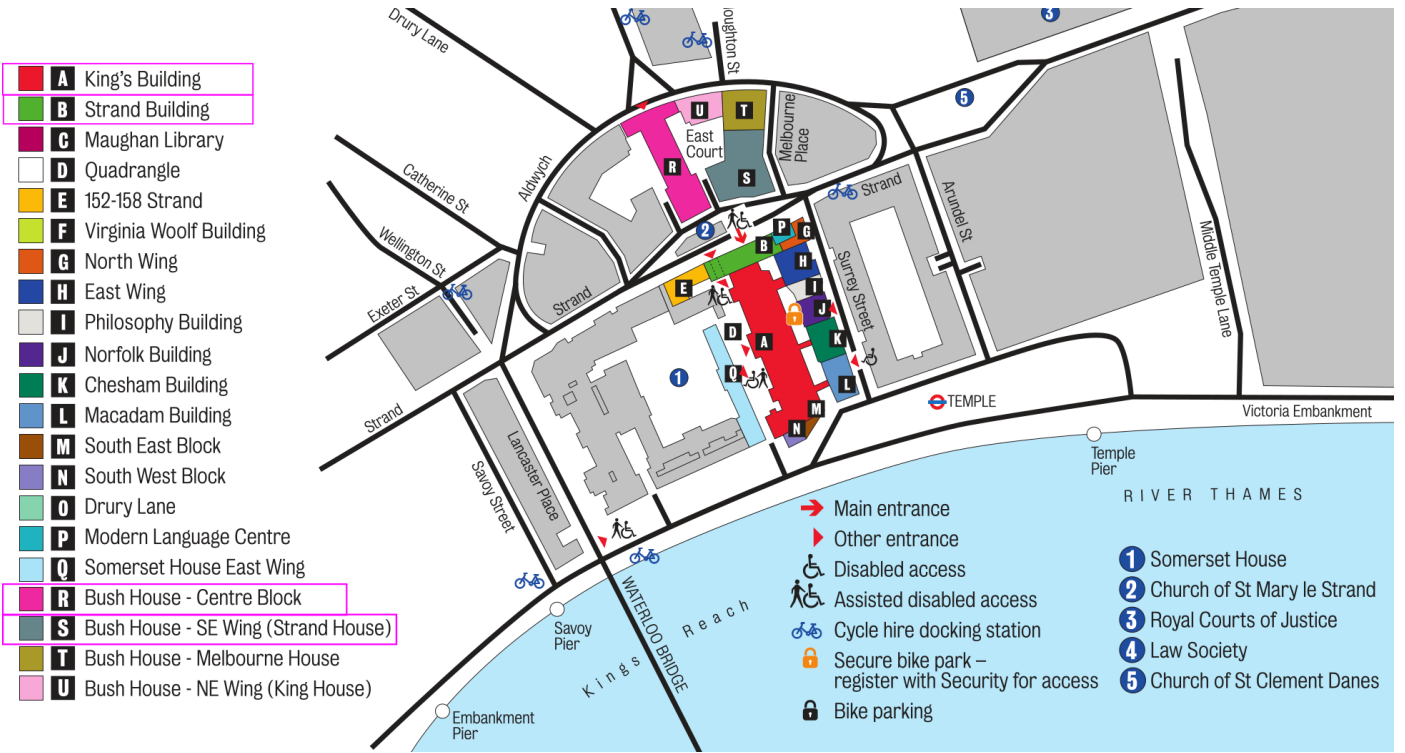
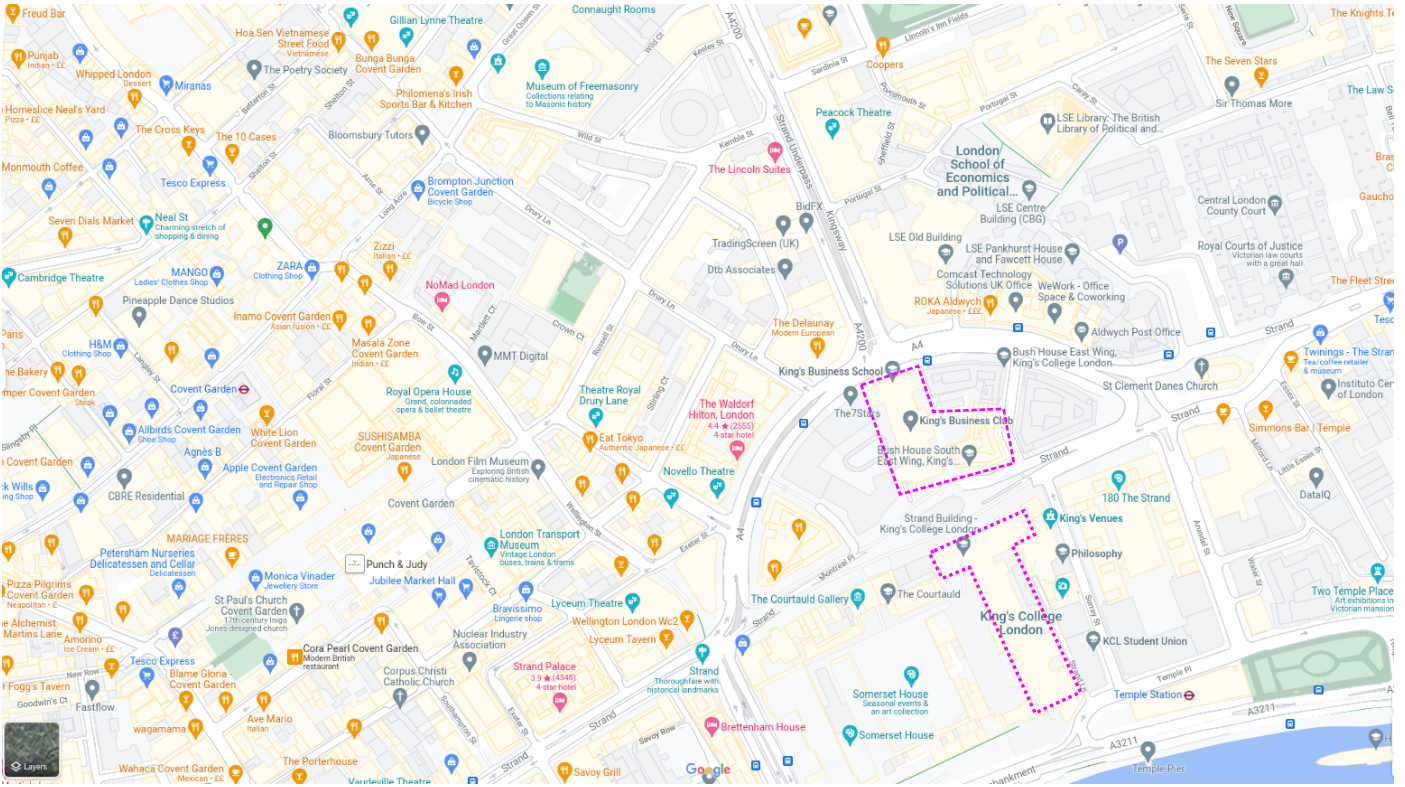

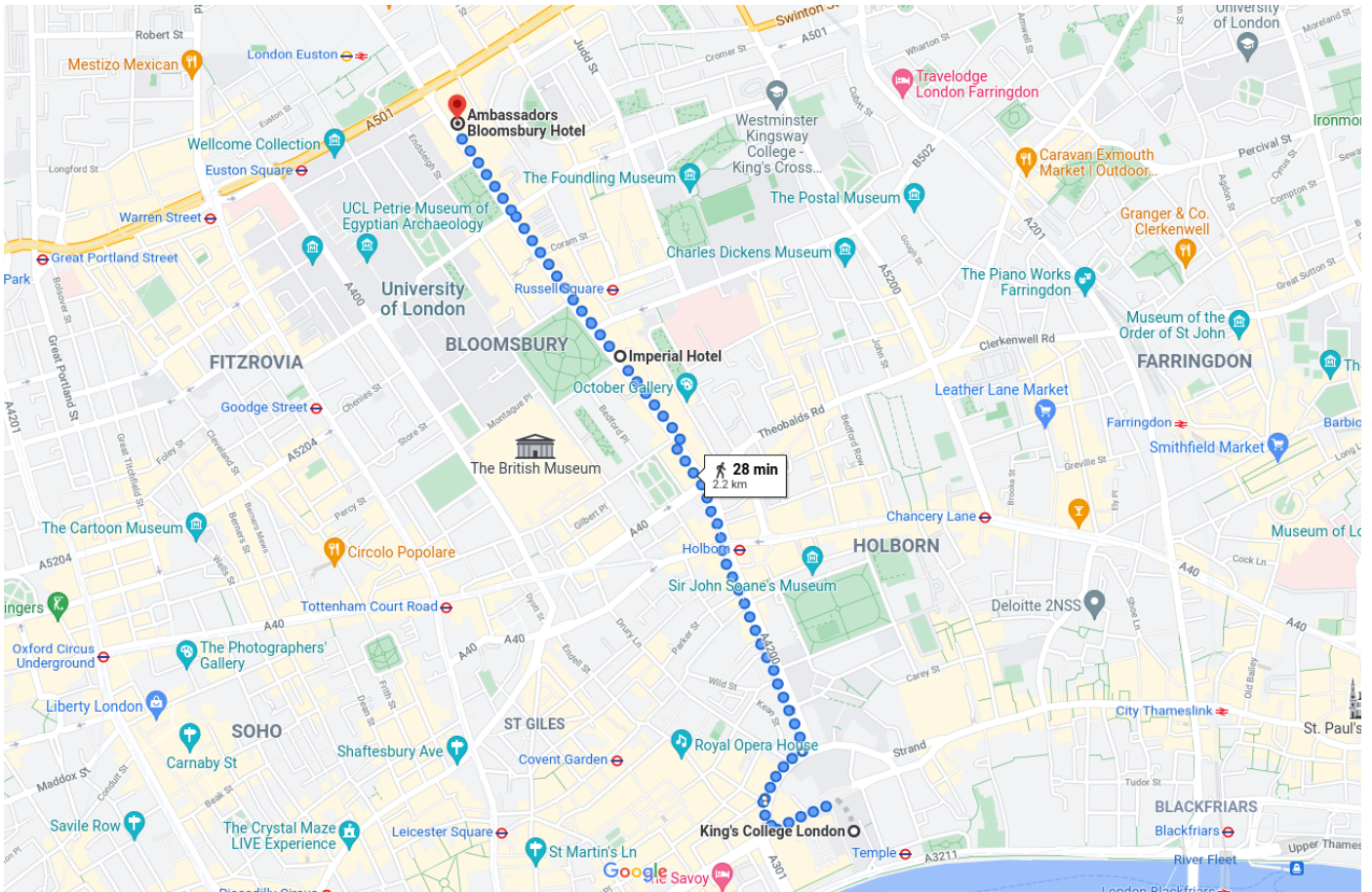

Floor maps

Bush House - Ground Floor

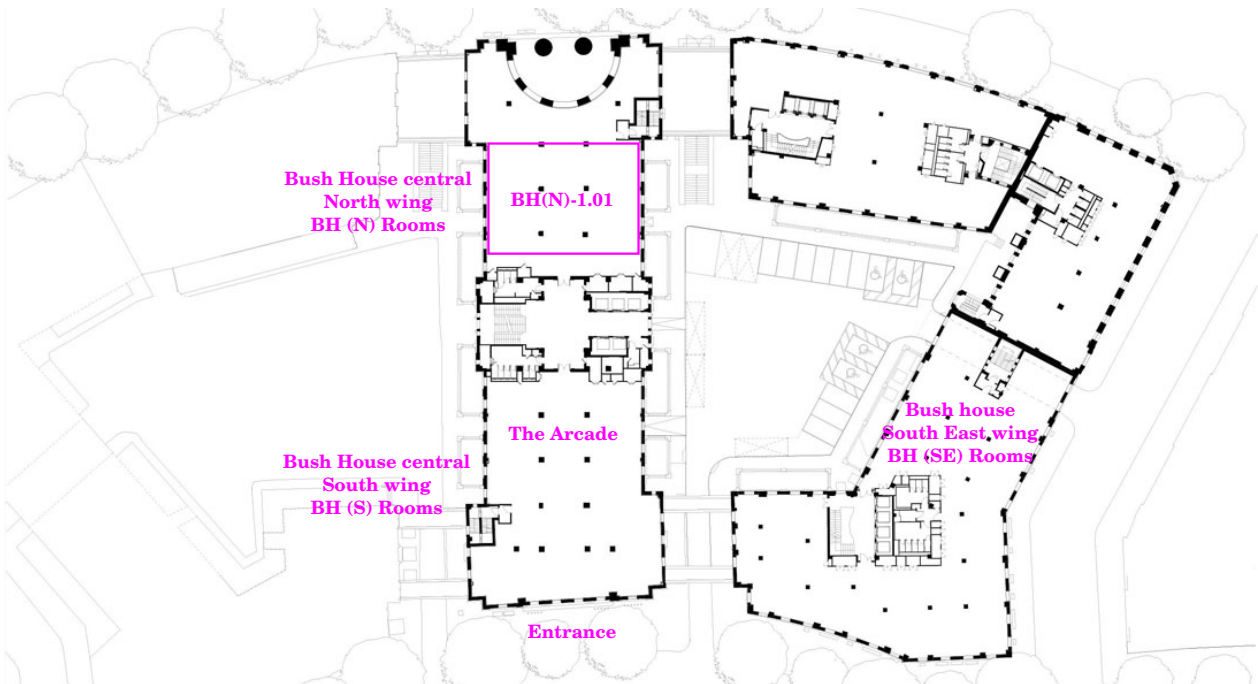

Bush House South Wing - First Floor

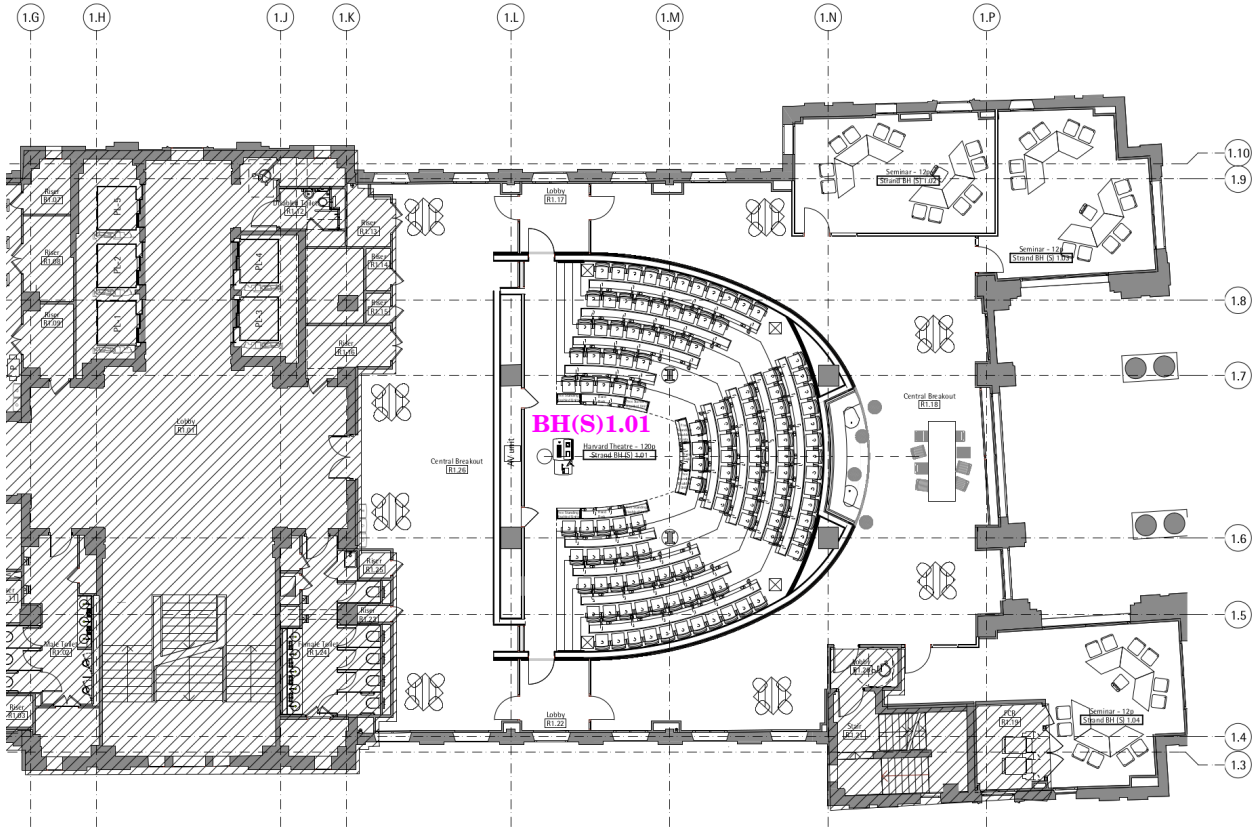

Bush House South Wing - Second Floor

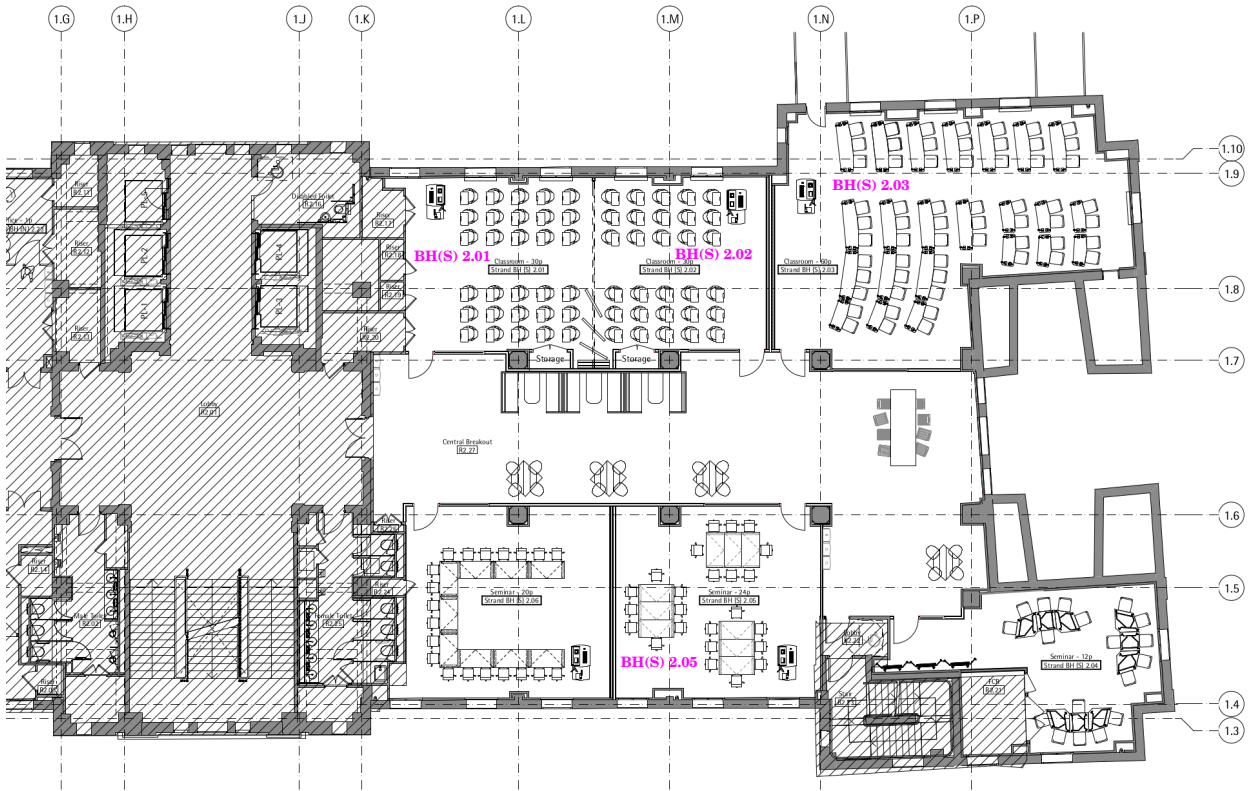

Bush House South East Wing - First Floor



Bush House South East Wing - Second Floor



Strand Campus

Strand Building – Basement 2

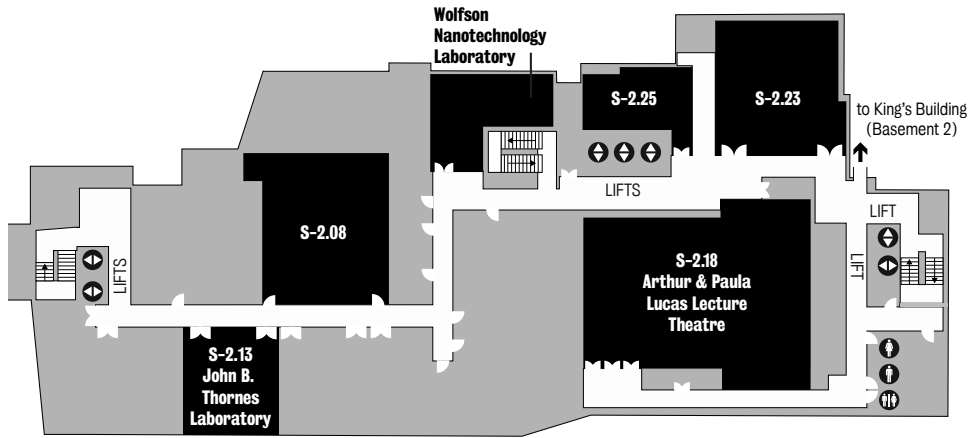

Strand Campus

Strand Building – Basement 1

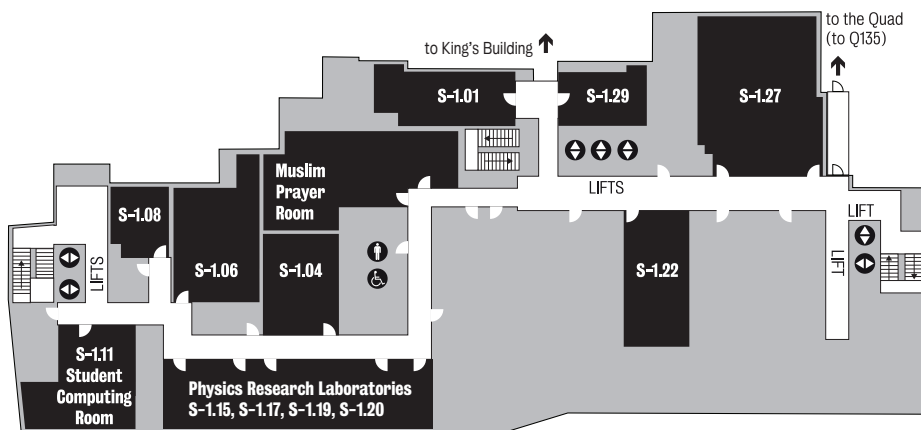

Strand Campus

Strand Building – Ground floor

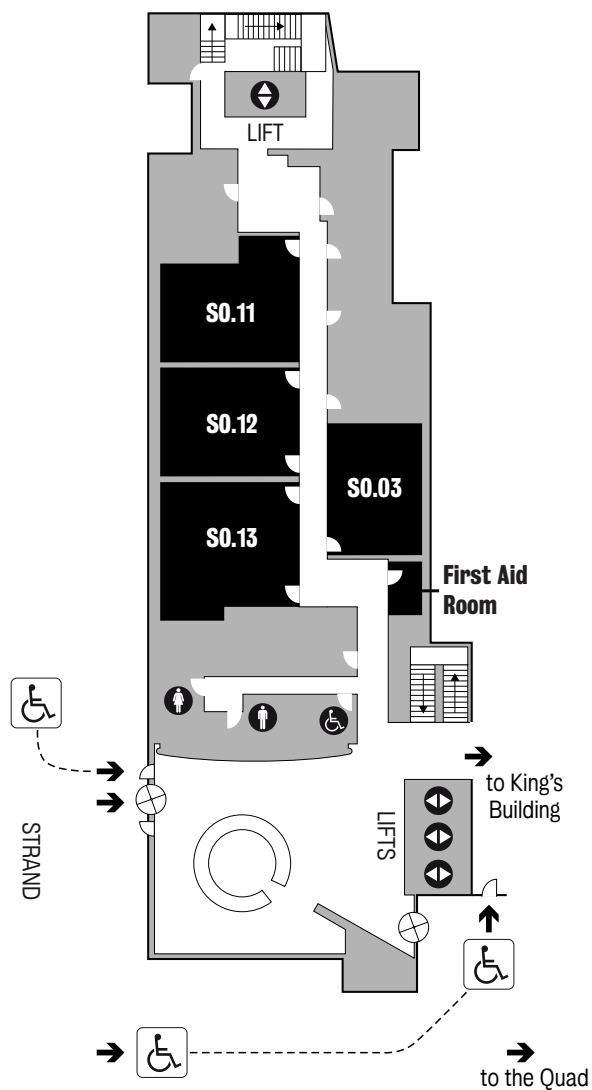

The non-stepped accessible route in to the building is to the rear of the main reception area. This route is via the black gated entrance and turn left. There is also a button-controlled self-opening door at the front of the main reception but this requires reception staff to activate it.

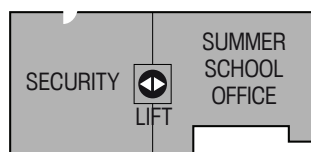

Strand Campus

King's Building - Level 0

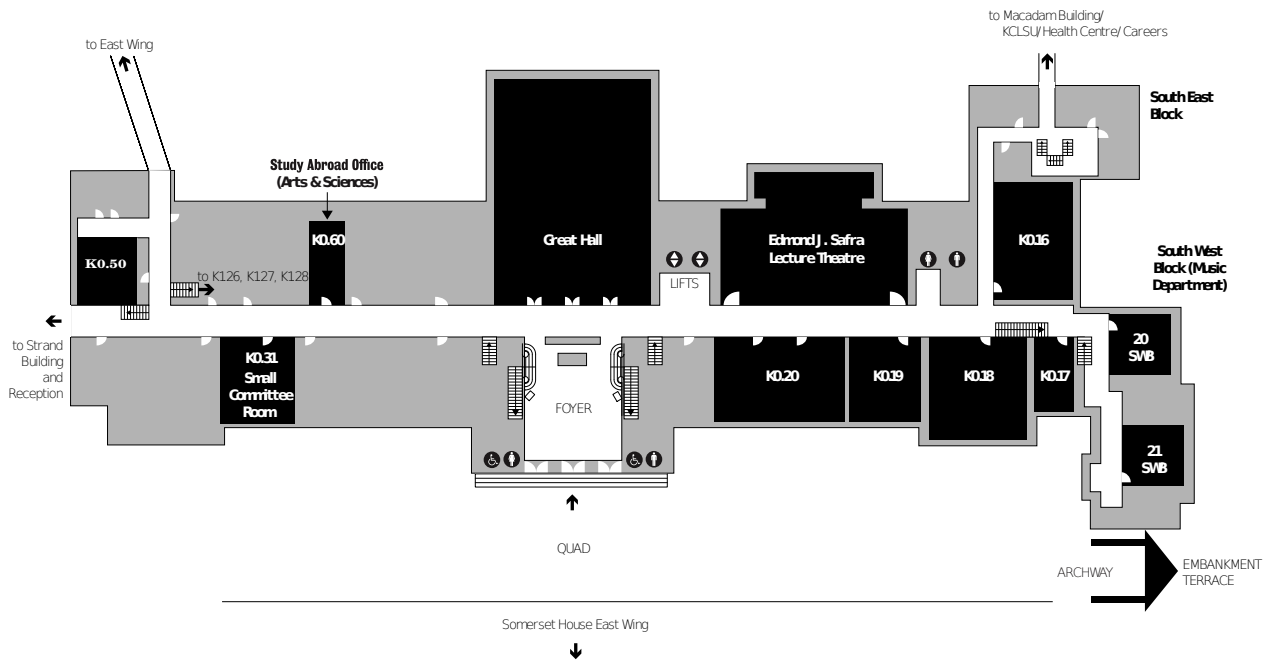

Strand Campus

King's Building - Level 2

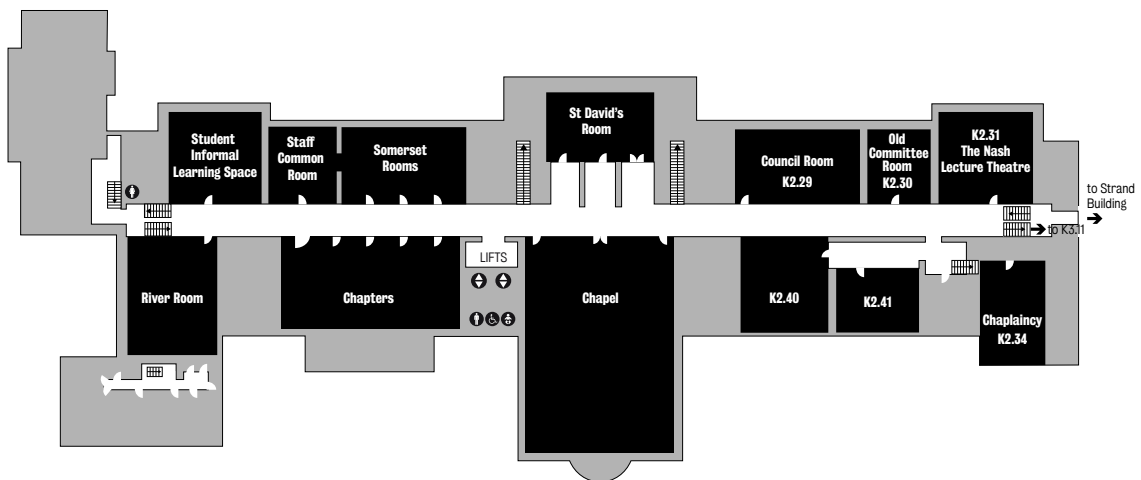

Keynote talk 1 **Room BH (N) -1.01** **Saturday 17.12.2022** **08:30 - 09:30**

DYNAMIC MODELS USING SCORE COPULA INNOVATIONS

Speaker: Michael Pitt, Kings College London, United Kingdom

Keynote talk 2 **Room Safra Lecture Theatre** **Saturday 17.12.2022** **08:30 - 09:30**

NEW GRAPHICAL DISPLAYS FOR CLASSIFICATION

Speaker: Peter Rousseeuw, KU Leuven, Belgium

Keynote talk 4 **Room Safra Lecture Theatre** **Monday 19.12.2022** **13:35 - 14:25**

THE ROLE OF ENERGY IN UK INFLATION AND PRODUCTIVITY

Speaker: Jennifer L Castle, Oxford University, United Kingdom

Keynote talk 3 **Room Safra Lecture Theatre** **Monday 19.12.2022** **18:45 - 19:40**

CONDITIONAL TAIL MOMENT AND REINSURANCE PREMIUM ESTIMATION UNDER RANDOM RIGHT CENSORING

Speaker: Armelle Guillou, Strasbourg university, France

Parallel Session C – CFE-CMStatistics **Saturday 17.12.2022** **10:00 - 12:05**

- EO655 RECENT ADVANCES IN TREE ENSEMBLE METHODS (Room S-2.23)
- EO585 ADVANCES IN MULTIVARIATE STATISTICS (Room S-1.04)
- EO264 ADVANCES IN MIXTURE MODELLING AND MODEL-BASED CLUSTERING (Room S-1.06)
- EO622 ADVANCES IN LONGITUDINAL DATA MODELING (Room S-1.27)
- EO624 ADVANCED METHODS FOR BAYESIAN MODELING (Room K0.19)
- EO629 EXTREME VALUE STATISTICS (Room K0.20)
- EO274 DESIGN OF EXPERIMENTS AND DATA ANALYSIS (Room K0.50)
- EO601 COMPLEXITY AND COMPUTATIONAL ASPECTS OF MCMC METHODS (Room S0.11)
- EO112 PROJECTION PURSUIT: THEORY (Room S0.13)
- EO060 METHODS AND APPLICATIONS FOR FUNCTIONAL DATA ANALYSIS (Room Safra Lecture Theatre)
- EO614 NON-REGULAR TECHNIQUES FOR STATISTICAL MODELING AND COMPUTING (Room Virtual R01)
- EO392 ADVANCES IN NON- AND SEMI-PARAMETRIC INFERENCE FOR COMPLEX DATA (Room Virtual R02)
- EO218 RECENT ADVANCES IN DIRECTIONAL STATISTICS (Room Virtual R03)
- EO648 ADVANCES IN ROBUST FUNCTIONAL AND HIGH DIMENSIONAL DATA ANALYSIS (Room Virtual R04)
- EO156 MODEL ASSESSMENT (Room K2.31 (Nash Lec. Theatre))
- EC825 APPLIED MACHINE LEARNING (Room S-2.25)
- EC821 STATISTICAL MODELLING I (Room S-1.01)
- EC807 SURVIVAL ANALYSIS I (Room S-1.22)
- EC816 NETWORK DATA (Room K0.16)
- EC754 TIME SERIES (Room K0.18)
- EC809 SPATIAL STATISTICS (Room S0.03)
- EC822 MULTIVARIATE STATISTICS AND COMPLEX DATA (Room S0.12)
- EC812 DIMENSION REDUCTION AND SHRINKAGE METHODS (Room K2.40)
- EC815 NEUROIMAGING (Room K2.41)
- CO645 REGULARISATION IN ECONOMETRIC MODELS (Room Virtual R05)
- CO030 CURRENT CHALLENGES TO MACRO AND FINANCIAL STABILITY (Room BH (S) 1.01 Lecture Theatre 1)
- CO358 RECENT DEVELOPMENTS IN STRUCTURAL VARS (Room BH (SE) 1.02)
- CO266 CREDIT RISK MODELLING (Room BH (SE) 1.05)
- CO366 CRYPTOCURRENCY ANALYTICS (Room BH (SE) 2.05)
- CO730 MEASURING CLIMATE-RELATED FINANCIAL RISKS (Room BH (SE) 2.10)
- CO036 TOPICS IN QUANTITATIVE FINANCE (Room BH (SE) 2.12)
- CC750 ECONOMETRIC MODELLING (Room BH (SE) 1.01)
- CC805 FINANCIAL ECONOMETRICS I (Room BH (SE) 1.06)
- CC769 COMPUTATIONAL AND HIGH-DIMENSIONAL ECONOMETRICS (Room BH (S) 2.02)
- CC780 APPLIED ECONOMETRICS (Room BH (S) 2.05)
- CC785 MACHINE LEARNING (Room BH (SE) 2.09)

Parallel Session D – CFE-CMStatistics **Saturday 17.12.2022** **13:35 - 15:40**

- EV746 STATISTICAL MODELLING (Room Virtual R01)
- EI009 STATISTICAL METHODS IN NEUROIMAGING (Room Safra Lecture Theatre)
- EO410 DIMENSION REDUCTION AND MODELING OF COMPLEX DATA STRUCTURES (Room S-2.23)
- EO623 EXPLAINABLE ARTIFICIAL INTELLIGENCE (Room S-2.25)
- EO122 RECENT ADVANCES IN MODEL SPECIFICATION TESTING (Room S-1.01)
- EO058 COPULAS AND DEPENDENCE MODELLING (Room S-1.04)
- EO696 RECENT ADVANCES IN MIXTURE MODELS (Room S-1.06)
- EO452 MISSING DATA ANALYSIS AND ITS APPLICATION (Room S-1.27)
- EO192 SPECTRAL METHODS IN STATISTICAL NETWORK INFERENCE (Room K0.16)
- EO250 COUNT DATA MODELS: DEVELOPMENTS AND APPLICATIONS (Room K0.18)
- EO532 RECENT ADVANCES IN STATISTICAL MODELING IN GENETICS AND BIOLOGICAL RESEARCH (Room K0.20)
- EO232 NEW CHALLENGES IN DESIGN OF EXPERIMENTS (Room K0.50)
- EO204 SPATIAL STATISTICS (Room S0.03)
- EO541 ROBUSTNESS AND RELATED TOPICS I (Room S0.12)
- EO793 SPORT ANALYTICS (Room S0.13)
- EO627 RECENT DEVELOPMENTS IN STATISTICAL MACHINE LEARNING (Room Virtual R02)
- EO615 RECENT ADVANCES IN CAUSAL INFERENCE AND HIGH-DIMENSIONAL STATISTICS (Room Virtual R03)
- EO234 RESAMPLING METHODS IN MODERN SETTINGS (Room Virtual R04)
- EO733 CAUSAL INFERENCE: CHALLENGES IN COMPLEX SETTINGS (Room Virtual R05)
- EO280 TIME SERIES WITH CHANGES IN REGIME (Room BH (SE) 1.01)
- EO718 EMPIRICAL PROCESSES AND THEIR APPLICATIONS (Room BH (S) 2.03)
- EO442 BAYESIAN MODELING AND APPLICATIONS (Room BH (S) 2.05)
- EO374 METHODOLOGY FOR SEMIPARAMETRIC AND CAUSAL INFERENCE (Room K2.31 (Nash Lec. Theatre))
- EO174 RECENT ADVANCES IN STATISTICS FOR HEALTH (Room K2.40)
- EO539 NEW ADVANCEMENTS IN UNDIRECTED GRAPHICAL/NETWORK MODELING (Room K2.41)
- EC813 SURVIVAL ANALYSIS II (Room S-1.22)
- EC775 NON- AND SEMI-PARAMETRIC STATISTICS (Room K0.19)
- EC778 METHODOLOGICAL AND APPLIED STATISTICS (Room S0.11)
- CI019 NEW ADVANCES IN INFERENCE (Room BH (S) 1.01 Lecture Theatre 1)
- CO128 DYNAMIC CONDITIONAL SCORE MODELS (Room BH (SE) 1.05)
- CO593 STRUCTURAL, PREDICTIVE INFERENCE IN NONLINEAR MACROECONOMETRICS (Room BH (SE) 2.05)
- CO693 LATEST DEVELOPMENTS IN FINANCIAL ECONOMETRICS (Room BH (SE) 2.10)
- CO398 RECENT ADVANCES IN QUANTITATIVE FINANCE (Room BH (SE) 2.12)
- CC761 FORECASTING (Room BH (SE) 1.02)
- CC781 FINANCIAL MODELLING (Room BH (SE) 1.06)
- CC798 INFLATION (Room BH (SE) 2.09)

Parallel Session E – CFE-CMStatistics **Saturday 17.12.2022** **16:10 - 17:50**

EI007 NEW DEVELOPMENTS FOR TIME SERIES ANALYSIS FOR COMPLEX DATA (Room Safra Lecture Theatre)
 EO612 PLATFORM TRIALS FOR COVID-19 INTERVENTIONS (Room S-2.23)
 EO340 STATISTICAL LEARNING IN PRACTICE (Room S-2.25)
 EO641 STATISTICAL MODELS FOR COMPLEX DEPENDENT DATA (Room S-1.04)
 EO713 RECENT ADVANCES IN IMAGING STATISTICS (Room S-1.06)
 EO450 STATISTICAL METHODS FOR WEARABLE DEVICES (Room S-1.27)
 EO536 MODELING VARIOUS DATA TYPES WITH NETWORK STRUCTURES (Room K0.16)
 EO326 MODELING AND COMPUTING FOR HETEROGENEOUS AND CLUSTERED DATA (Room K0.19)
 EO619 ROC METHODS FOR THE EVALUATION OF BIOMARKERS (Room K0.20)
 EO028 ADVANCES IN DESIGN OF EXPERIMENTS (Room K0.50)
 EO638 SPATIAL STATISTICS AND STOCHASTIC PDES (Room S0.03)
 EO444 BRANCHING PROCESSES: THEORY, COMPUTATION AND APPLICATIONS I (Room S0.11)
 EO148 STATISTICAL SUMMITS: METHODOLOGY AND COMPUTING I (Room S0.13)
 EO404 RECENT ADVANCES IN BAYESIAN MODELING AND COMPUTATION (Room Virtual R01)
 EO230 ADVANCES IN HIGH-DIMENSIONAL STATISTICS (Room Virtual R02)
 EO664 ADVANCE IN APPLICATION OF FUNCTIONAL DATA ANALYSIS (Room Virtual R03)
 EO512 EMERGING STATISTICAL ISSUES IN OVERPARAMETERIZED MODELING (Room Virtual R04)
 EO052 NEW APPROACHES IN HIGH-DIMENSIONAL TIME SERIES MODELING (Room Virtual R05)
 EO542 ROBUSTNESS AND RELATED TOPICS II (Room Virtual R06)
 EO720 BAYESIAN NONPARAMETRICS FOR CAUSAL INFERENCE: PART I (Room Virtual R07)
 EO670 STATISTICAL METHODS FOR MASSIVE OR HIGH-DIMENSIONAL DATA (Room Virtual R08)
 EO116 BAYESIAN SEMI- AND NON-PARAMETRIC METHODS I (Room BH (S) 2.05)
 EO386 WEIGHTING METHODS FOR CAUSAL INFERENCE AND SELECTION BIAS (Room K2.31 (Nash Lec. Theatre))
 EO182 RECENT DEVELOPMENTS IN FUNCTIONAL DATA ANALYSIS (Room K2.40)
 EO563 STATISTICAL METHODS FOR NEUROIMAGING DATA (Room K2.41)
 CO364 RECENT ADVANCES IN PROBABILISTIC FORECASTING (Room BH (S) 1.01 Lecture Theatre 1)
 CO618 REGIME SWITCHING MODELS (Room BH (SE) 1.01)
 CO142 BUSINESS CYCLES AND MACROECONOMIC POLICY (Room BH (SE) 1.02)
 CO470 PERSISTENT TIME SERIES (Room BH (SE) 1.06)
 CO206 DYNAMIC ANALYSIS OF CRYPTOCURRENCY (Room BH (S) 2.02)
 CO639 HIGH DIMENSIONAL METHODS IN TRACKING INFLATION AND BUSINESS CYCLES (Room BH (S) 2.03)
 CO100 BAYESIAN METHODS FOR EMPIRICAL MACROECONOMICS (Room BH (SE) 2.05)
 CO332 ECONOMETRIC FORECASTING (Room BH (SE) 2.09)
 CO136 MACHINE LEARNING IN ASSET PRICING (Room BH (SE) 2.10)
 CO306 FINANCIAL ENGINEERING (Room BH (SE) 2.12)
 CC803 REALIZED VOLATILITY (Room BH (SE) 1.05)

Parallel Session F – CFE-CMStatistics

Saturday 17.12.2022

18:05 - 19:20

EO669 ADVANCES IN MHEALTH METHODS (Room S-2.23)
 EO362 STATISTICAL AND MACHINE LEARNING METHODS FOR ANALYSIS OF EHR/RWD (Room S-2.25)
 EO438 FINITE POPULATION INFERENCE USING ML AND LATENT VARIABLE MODELS (Room S-1.01)
 EO426 NEW ALTERNATIVES TO SIGNIFICANCE TESTING (Room S-1.06)
 EO196 SCREENING AND VARIABLE SELECTION IN HIGH-DIMENSIONAL SURVIVAL DATA (Room S-1.22)
 EO420 ADVANCES IN STATISTICAL NEUROIMAGING AND SPATIO-TEMPORAL MODELING (Room S-1.27)
 EO388 STATISTICAL METHODS FOR CONSTRUCTING AND ANALYZING NETWORKS (VIRTUAL) (Room K0.16)
 EO658 ADVANCES IN BAYESIAN METHODS TO RECORD LINKAGE AND SURVEY METHODOLOGY (Room K0.18)
 EO572 ADVANCES IN BAYESIAN COMPUTATIONS (Room K0.19)
 EO579 RECENT ADVANCES IN CAUSAL MEDIATION ANALYSIS (Room K0.20)
 EO632 DESIGN OF EXPERIMENTS (Room K0.50)
 EO573 SPATIAL AND SPATIO-TEMPORAL STATISTICS IN URBAN AND NATURAL CONTEXTS (Room S0.03)
 EO282 RECENT ADVANCEMENTS IN POINT PROCESS MODELS (Room S0.11)
 EO272 NEW BAYESIAN APPROACHES FOR VARIABLE SELECTION (Room S0.12)
 EO568 RECENT ADVANCES IN STOCHASTIC MODELS (Room Virtual R01)
 EO613 COMBINING CLINICAL TRIALS AND OBSERVATIONAL STUDY DATA (Room Virtual R02)
 EO496 STATISTICAL INFERENCE AND EXPLAINABLE MACHINE LEARNING (Room Virtual R04)
 EO166 STATISTICS OF EXTREME VALUES (Room Virtual R05)
 EO616 RECENT DEVELOPMENTS IN NONPARAMETRIC STATISTICS (Room Virtual R06)
 EO566 DATA INTEGRATION IN SURVEY SAMPLING (Room Virtual R07)
 EO637 INFERENCE UNDER HETEROGENEITY (Room K2.31 (Nash Lec. Theatre))
 EO587 CAUSAL INFERENCE: RECENT CHALLENGES AND DEBATES (Room K2.40)
 EO238 HIGH-DIMENSIONAL DATA ANALYSIS AND SPECTRAL METHODS (VIRTUAL) (Room K2.41)
 EC808 COPULAS (Room S-1.04)
 EC774 METHODOLOGICAL STATISTICS (Room S0.13)
 CO038 REGIME CHANGE MODELING I (Room Virtual R03)
 CO454 INFLATION DYNAMICS (Room Virtual R08)
 CO088 SUSTAINABLE FINANCE (Room BH (S) 1.01 Lecture Theatre 1)
 CO034 ADVANCES IN TIME SERIES ECONOMETRICS (Room BH (SE) 1.01)
 CO737 ECONOMETRIC ANALYSIS OF FINANCIAL INSTITUTIONS (Room BH (SE) 1.05)
 CO144 HIGH-DIMENSIONAL TIME SERIES ANALYSIS AND APPLICATIONS (Room BH (SE) 1.06)
 CO731 MACHINE LEARNING MEETS ECONOMETRICS (Room BH (SE) 2.09)
 CO140 DEVELOPMENTS IN RISKY ASSET RETURNS DECOMPOSITION METHODS (Room BH (SE) 2.10)
 CO458 ECONOMETRICS OF ART MARKETS (Room BH (SE) 2.12)
 CC799 ELECTRICITY MARKETS (Room BH (S) 2.03)
 CC764 MACROECONOMETRICS I (Room BH (SE) 2.05)

Parallel Session G – CFE-CMStatistics

Sunday 18.12.2022

08:15 - 09:55

EO595 RECENT DEVELOPMENTS IN LEARNING THEORY (Room S-2.25)
 EO704 ADVANCES IN HILBERT STATISTICS AND APPLICATION TO DISTRIBUTIONAL DATA (Room S-1.01)
 EO709 MODELING COMPLEX DATA AND INTERACTIONS (Room S-1.06)
 EO708 RELIABILITY AND STOCHASTICS: THEORY AND APPLICATIONS (Room S-1.22)
 EO054 ADVANCES ON MODELS FOR TIME SERIES AND LONGITUDINAL DATA (Room S-1.27)
 EO651 GOODNESS-OF FIT AND MODEL SELECTION PROCEDURES (Room K0.16)
 EO500 DESIGN OF EXPERIMENTS AND APPLICATIONS (Room K0.50)
 EO672 SPATIAL AND TEMPORAL MODELING IN THE CLIMATE AND ENVIRONMENTAL SCIENCES (Room S0.03)
 EO236 THEORY AND COMPUTATION IN INFERENCE FOR STOCHASTIC PROCESSES (Room S0.11)
 EO074 PROJECTION PURSUIT: APPLICATIONS (Room S0.13)
 EO600 ADVANCES IN FLEXIBLE REGRESSION MODELLING (Room Safra Lecture Theatre)
 EO430 CLUSTERING APPROACHES FOR NOISY DATA (Room Virtual R02)
 EO697 DEPENDENCE MODELS FOR COMPOUND EVENTS (Room Virtual R04)
 EO216 HAWKES PROCESSES IN FINANCE (Room BH (SE) 1.02)
 EO154 GRAPHICAL MARKOV MODELS II (Room BH (S) 2.02)
 EO464 ADVANCES IN VARIATIONAL APPROXIMATIONS (Room BH (S) 2.05)
 EO310 MODERN DIRECTIONAL STATISTICS (Room K2.31 (Nash Lec. Theatre))

EO576 ADVANCES IN JOINT MEANCOVARIANCE MODELS FOR MULTIVARIATE DATA (VIRTUAL) (Room K2.41)
 EC385 MULTIVARIATE STATISTICS (Room S-2.23)
 EC814 VARIABLE SELECTION (Room S-1.04)
 EC789 BIOSTATISTICS (Room K0.18)
 EC757 HIGH-DIMENSIONAL STATISTICS (Room K0.19)
 EC811 EXTREME VALUES (Room K0.20)
 EC810 ROBUST STATISTICS AND DEPTH FUNCTIONS (Room S0.12)
 CO617 BAYESIAN ANALYSIS OF FINANCE AND MACROECONOMICS (Room Virtual R01)
 CO547 NEW METHODS IN MULTIVARIATE BAYESIAN MODELING (Room Virtual R03)
 CO322 CRYPTOCURRENCY PRICE DYNAMICS (Room BH (S) 1.01 Lecture Theatre 1)
 CO168 STRUCTURAL INFORMATION IN ESTIMATING ASSET PRICING MODELS (Room BH (SE) 1.01)
 CO460 TOPICS IN APPLIED ECONOMETRICS (Room BH (SE) 1.05)
 CO104 TIME SERIES ECONOMETRICS (Room BH (S) 2.03)
 CO528 ADVANCES IN QUANTITATIVE FINANCE AND INSURANCE (Room BH (SE) 2.05)
 CO132 MIDAS AND ZOMBIES IN MACROECONOMICS (Room BH (SE) 2.09)
 CO138 RECENT ADVANCES IN FINANCIAL ECONOMETRICS AND EMPIRICAL ASSET PRICING (Room BH (SE) 2.10)
 CO742 CLIMATE CHANGE ECONOMETRICS AND FINANCIAL MARKETS (Room BH (SE) 2.12)
 CC748 FINANCIAL ECONOMETRICS II (Room BH (SE) 1.06)

Parallel Session H – CFE-CMStatistics

Sunday 18.12.2022

10:25 - 12:05

EO103 GRAND CHALLENGES AND ADVANCES IN BAYESIAN COMPUTATION (Room Safra Lecture Theatre)
 EO701 THE STEIN METHOD AND STATISTICS (Room S-2.25)
 EO130 RECENT ADVANCES IN CLUSTERING OF MIXED-TYPE DATA (Room S-1.06)
 EO665 ADVANCES AND CHALLENGES IN ACCELERATED LIFE TESTING (Room S-1.22)
 EO660 LATENT VARIABLE MODELS FOR COMPLEX DATA STRUCTURES (Room S-1.27)
 EO082 STATISTICAL MODELLING OF NETWORK DATA (Room K0.16)
 EO599 QUANTILE METHODS AND APPLICATIONS (Room K0.18)
 EO056 GRAPHICAL MARKOV MODELS I (Room K0.19)
 EO490 STATISTICAL ANALYSIS IN NON-EUCLIDEAN SPACES (Room K0.20)
 EO636 HIGH DIMENSIONAL DATA ANALYTICS: TOOLS, TRICKS, TIPS AND PITFALLS (Room K0.50)
 EO446 BRANCHING PROCESSES: THEORY, COMPUTATION AND APPLICATIONS II (Room S0.03)
 EO436 ASYMPTOTIC THEORY APPLIED TO STATISTICAL COMPUTATION AND SIMULATION (Room S0.11)
 EO580 DISTRIBUTIONAL MODEL VALIDATION (Room S0.12)
 EO498 STATISTICS OF HIGH-FREQUENCY DATA I (Room S0.13)
 EO220 ADVANCES IN FUNCTIONAL DATA ANALYSIS AND NONPARAMETRIC REGRESSION (Room Virtual R01)
 EO597 INNOVATIVE APPROACHES FOR UNSUPERVISED CLASSIFICATION METHODS (Room Virtual R02)
 EO558 DEPENDENCY IN BAYESIAN MIXTURE MODELS AND BEYOND (Room BH (S) 2.02)
 EO677 DEVELOPMENTS AND APPLICATIONS OF APPROXIMATE BAYESIAN COMPUTATION (Room BH (S) 2.05)
 EO086 ADVANCES IN BAYESIAN COMPUTATION TECHNIQUES I (Room BH (SE) 2.05)
 EO110 ADVANCEMENTS IN SPATIAL AND SPATIO-TEMPORAL MODELS (Room K2.31 (Nash Lec. Theatre))
 EO062 RECENT ADVANCES IN FUNCTIONAL DATA ANALYSIS (Room K2.40)
 EO646 ADVANCES IN STATISTICAL MODELING WITH NEURAL NETWORKS (Room K2.41)
 EC788 MACHINE LEARNING (Room S-2.23)
 EC771 COMPUTATIONAL STATISTICS I (Room S-1.04)
 EC829 MCMC ALGORITHMS (Room BH (S) 2.03)
 EP001 POSTER SESSION I (ONLY VIRTUAL) (Room Posters Virtual Room 1)
 CO096 RISK ANALYSIS AND ASSESSMENT IN ECONOMICS AND FINANCE (Room S-1.01)
 CO396 MODELLING FINANCIAL MARKETS (Room Virtual R03)
 CO520 DATA ANALYSIS TOOLS FOR BAYESIAN INFERENCE (Room Virtual R04)
 CO084 MODELLING ECONOMIC AND FINANCIAL TIME SERIES (Room BH (S) 1.01 Lecture Theatre 1)
 CO080 ADVANCES IN TIME SERIES METHODS (Room BH (SE) 1.01)
 CO738 COMMODITIES: PRICING AND TRADING (Room BH (SE) 1.02)
 CO546 ADVANCES IN CLIMATE AND ENERGY ECONOMICS (Room BH (SE) 1.05)
 CO106 FACTOR AND GARCH MODELS (Room BH (SE) 1.06)
 CO736 RECENT DEVELOPMENTS IN PERSONAL CREDIT RISK MODELLING (Room BH (SE) 2.09)
 CO076 TOPICS IN FINANCIAL ECONOMETRICS (Room BH (SE) 2.10)
 CO694 ANOMALY DETECTION AND FORECASTING USING MACHINE LEARNING METHODS (Room BH (SE) 2.12)

Parallel Session I – CFE-CMStatistics

Sunday 18.12.2022

13:35 - 15:15

EO120 TOPICS IN DIMENSION REDUCTION (Room S-2.23)
 EO324 TEXT ANALYSIS FOR COMPLEX DATA (Room S-1.01)
 EO745 RECENT ADVANCES IN COPULA REGRESSION (Room S-1.04)
 EO598 MIXTURE MODELLING (Room S-1.06)
 EO642 NEW DEVELOPMENTS IN CENSORED AND TRUNCATED DATA (Room S-1.22)
 EO741 TESTING INDEPENDENCE IN HIGH-DIMENSIONAL STATISTICS (Room S-1.27)
 EO554 ADVANCES IN NETWORK DATA ANALYSIS (Room K0.16)
 EO649 RECENT DEVELOPMENT IN MEDIATION ANALYSIS (Room K0.19)
 EO488 STATISTICAL METHODS FOR MISSING DATA AND MEASUREMENT ERROR (Room K0.20)
 EO422 RECENT ADVANCES IN NONPARAMETRIC METHODS (Room K0.50)
 EO584 SPATIAL TRANSCRIPTOMICS DATA MODELING AND ANALYSIS (Room S0.03)
 EO594 MODAL INFERENCE (Room S0.13)
 EO557 STATISTICAL INFERENCE ON FUNCTIONAL TIME SERIES (Room Safra Lecture Theatre)
 EO631 STATISTICAL ADVANCES IN BIOMEDICAL RESEARCH (Room Virtual R01)
 EO526 RECENT ADVANCES IN STATISTICAL INFERENCE (Room Virtual R02)
 EO633 COUNTERFACTUAL ANALYSIS AND OPTIMAL POLICY (Room Virtual R03)
 EO552 NOVEL METHODS IN MICROBIOME DATA ANALYSIS (Room Virtual R04)
 EO628 RECENT DEVELOPMENTS IN SURVIVAL ANALYSIS (Room Virtual R05)
 EO671 ADVANCES IN GENERATIVE MODELLING (Room Virtual R06)
 EO538 STATISTICAL ANALYSIS OF COMPLEX DEPENDENT DATA (Room Virtual R07)
 EO494 NOVEL STATISTICAL DEVELOPMENTS FOR ECONOMICS AND FINANCE (Room Virtual R08)
 EO124 APPLICATIONS OF DATA SCIENCE IN CAUSAL INFERENCE, IMAGING, AND FINANCE (Room BH (SE) 1.02)
 EO050 ROBUST CAUSAL INFERENCE IN BIOLOGY AND ECONOMICS (Room BH (SE) 1.05)
 EO668 STRUCTURED PRIOR DISTRIBUTIONS FOR COMPLEX MODELS (Room BH (S) 2.02)
 EO743 BAYESIAN AND ROBUST INSIGHTS IN DATA ANALYSIS AND CLASSIFICATION (Room BH (S) 2.03)
 EO625 COMPUTATIONS AND METHODS IN BAYESIAN NONPARAMETRICS (Room BH (S) 2.05)
 EO068 INNOVATIVE AND PRACTICAL STRATEGIES IN CAUSAL INFERENCE (Room K2.31 (Nash Lec. Theatre))
 EO703 STATISTICAL METHODS IN BRAIN IMAGING (Room K2.40)
 EO176 RANDOM MATRIX THEORY AND ITS APPLICATIONS (Room K2.41)
 EC824 STATISTICS FOR IMAGES AND BRAIN SIGNALS (Room K0.18)
 EC819 STATISTICS AND ECONOMETRICS MODELLING AND APPLICATIONS (Room S0.11)
 CI017 RECENT ADVANCES IN QUANTILE REGRESSION (Room BH (S) 1.01 Lecture Theatre 1)
 CO605 ROBUST ESTIMATION IN STOCHASTIC FRONTIER MODELS (Room S0.12)
 CO208 ADVANCES IN SEMIPARAMETRIC MODELS FOR PANEL DATA (Room BH (SE) 1.01)

CO042 REGIME CHANGE MODELING II (VIRTUAL) (Room BH (SE) 2.05)
CO424 CONTEMPORARY ISSUES IN MODELLING AND FORECASTING INFLATION (Room BH (SE) 2.09)
CO146 PARAMETER UNCERTAINTY IN PORTFOLIO OPTIMIZATION AND ASSET PRICING (Room BH (SE) 2.10)
CO400 STATISTICAL ANALYSIS OF CLIMATE DATA (Room BH (SE) 2.12)

Parallel Session J – CFE-CMStatistics

Sunday 18.12.2022

15:45 - 17:00

EV772 COMPUTATIONAL STATISTICS (Room Virtual R06)
EO518 ADVANCES IN STATISTICAL METHODS FOR BOUNDED DATA (Room S-2.23)
EO716 RECENT ADVANCES IN LEARNING UNDER DISTRIBUTION SHIFTS (Room S-2.25)
EO620 CLUSTERING OF COMPLEX DATA STRUCTURES (Room S-1.01)
EO186 MARGINAL AND CONDITIONAL INFERENCE FOR DEPENDENT DATA (Room S-1.04)
EO662 ADVANCES IN NONPARAMETRIC CONTROL CHARTS (Room S-1.06)
EO735 ENTITY RESOLUTION, BIOMEDICAL AND NUCLEAR FORENSICS DATA MODELING (Room S-1.22)
EO150 MODEL-FREE INFERENCE (VIRTUAL) (Room S-1.27)
EO712 ADVANCES IN MULTIPLE NETWORK DATA ANALYSIS (Room K0.16)
EO634 BAYESIAN NONPARAMETRICS FOR CAUSAL INFERENCE: PART II (Room K0.18)
EO705 ADVANCES IN EXTREME VALUE STATISTICS (Room K0.20)
EO342 SPATIAL DATA SCIENCE (Room S0.03)
EO260 BAYESIAN SEMI- AND NON-PARAMETRIC METHODS III (Room S0.11)
EO626 RECENT DEVELOPMENTS IN ROBUST MODEL SELECTION (Room S0.12)
EO502 STATISTICS OF HIGH-FREQUENCY DATA II (Room S0.13)
EO408 LONGITUDINAL DATA ANALYSIS (Room Virtual R01)
EO336 BAYESIAN CONTRIBUTIONS TO SURVEY METHODOLOGY (Room Virtual R02)
EO553 FEDERATE LEARNING AND DATA PRIVACY IN MODERN DATA ANALYSIS (Room Virtual R03)
EO368 BIostatistics IN RENAL RESEARCH (Room Virtual R04)
EO548 CAUSAL MACHINE LEARNING (Room Virtual R05)
EO376 NEW STATISTICAL ADVANCES IN THE ANALYSIS OF WEARABLE DEVICE DATA (Room Virtual R07)
EO592 HIGH-DIMENSIONAL PROBABILITY AND STATISTICS (Room Virtual R08)
EO380 RECENT ADVANCES IN MEDIATION ANALYSIS (Room K2.31 (Nash Lec. Theatre))
EO607 RECENT DEVELOPMENTS IN UNLINKED REGRESSION (Room K2.40)
EO549 THEORY AND METHODS IN HIGH DIMENSIONAL 'OMIC' DATA (Room K2.41)
EC806 DESIGN OF EXPERIMENTS (Room K0.50)
CO078 FINANCIAL TIME SERIES (Room BH (S) 1.01 Lecture Theatre 1)
CO194 RECENT DEVELOPMENTS IN MODELLING AND FORECASTING EXTREMES (Room BH (SE) 1.01)
CO098 MACROECONOMETRICS (Room BH (SE) 1.05)
CO108 EMPIRICAL ASPECTS OF CRYPTOCURRENCY MARKETS (Room BH (S) 2.02)
CO581 ADVANCES IN QUANTILE REGRESSION (Room BH (S) 2.03)
CO252 RECENT ADVANCES IN HIGH-DIMENSIONAL ECONOMETRICS (Room BH (S) 2.05)
CO722 NEWS AND THE TERM STRUCTURE OF INTEREST RATES (Room BH (SE) 2.05)
CO300 DYNAMIC MULTIPLE QUANTILE MODELS (Room BH (SE) 2.09)
CO276 FINANCIAL MODELLING AND FORECASTING (Room BH (SE) 2.10)
CO611 RISK, VOLATILITY AND PRICE DISCOVERY IN FINANCIAL MARKETS (Room BH (SE) 2.12)
CC795 ASSET PRICING (Room BH (SE) 1.02)
CC800 REGIME SWITCHING (Room BH (SE) 1.06)

Parallel Session K – CFE-CMStatistics

Sunday 18.12.2022

17:15 - 19:20

EI025 SPECIAL INVITED SESSION IN MEMORY OF DAVID COX (Room Safra Lecture Theatre)
EO707 RECENT STATISTICAL ADVANCES IN IMAGING (Room S-2.23)
EO378 MODERN TOPICS IN STATISTICAL LEARNING (Room S-2.25)
EO190 ADVANCEMENTS IN THE ANALYSIS OF HIGH-DIMENSIONAL AND COMPLEX DATA (Room S-1.01)
EO352 ADVANCES IN MULTIVARIATE ANALYSIS: CLUSTERING, FACTOR MODELS, AND MORE (Room S-1.06)
EO350 BEYOND PROPORTIONAL HAZARDS AND STANDARD SURVIVAL (Room S-1.22)
EO578 ADVANCES IN STATISTICAL METHODOLOGY FOR THE ANALYSIS OF LONGITUDINAL DATA (Room S-1.27)
EO630 MODELING OF COMPLEX HIGH DIMENSIONAL DATA IN NEUROSCIENCE (Room K0.16)
EO180 ROBUST STATISTICS: A DATA DEPTH APPROACH (Room K0.18)
EO188 MACHINE LEARNING FOR EXTREMES (Room K0.20)
EO262 SPATIO-TEMPORAL HEALTH MODELING: DEVELOPMENTS (Room S0.03)
EO162 STATISTICAL OPTIMAL TRANSPORT (VIRTUAL) (Room S0.11)
EO545 PREDICTING AND FORECASTING FOR COMPLEX DATA (Room S0.12)
EO222 PROJECTION PURSUIT: PREDICTION (Room S0.13)
EO254 GEOSPATIAL HARMONIZATION: DYNAMIC PREDICTION AND MAPPING (Room Virtual R02)
EO312 STATISTICAL METHODS IN CAUSAL INFERENCE AND REINFORCEMENT LEARNING (Room Virtual R03)
EO744 STATISTICAL LEARNING IN MODERN COMPLEX DATA ANALYSIS (Room Virtual R04)
EO570 RECENT ADVANCES IN STOCHASTIC MODELS II (Room Virtual R05)
EO723 CAUSAL INFERENCE IN NETWORK SETTINGS (Room Virtual R06)
EO158 BAYESIAN SEMI- AND NON-PARAMETRIC METHODS II (Room Virtual R07)
EO284 RECENT DEVELOPMENTS IN OPTIMAL DESIGNS (Room Virtual R08)
EO685 ADVANCES IN BAYESIAN FACTOR ANALYSIS (Room BH (S) 2.05)
EO214 MODERN METHODS FOR CAUSAL INFERENCE (Room K2.31 (Nash Lec. Theatre))
EO268 NEW FRONTIERS IN COMPLEX AND FUNCTIONAL DATA ANALYSES (VIRTUAL) (Room K2.40)
EO575 METHODS AND ALGORITHMS IN CONTEMPORARY DATA ANALYSIS (Room K2.41)
EC384 STATISTICAL MODELLING II (Room S-1.04)
EC827 APPLIED STATISTICS (Room K0.19)
EC817 BAYESIAN STATISTICS I (Room BH (S) 2.03)
EP027 POSTER SESSION II (ONLY VIRTUAL) (Room Posters Virtual Room 1)
CI021 MACHINE LEARNING AND MACROECONOMIC FORECAST (Room BH (S) 1.01 Lecture Theatre 1)
CO242 NEW APPROACHES TO TIME SERIES ANALYSIS FOR MACRO AND FINANCE (Room Virtual R01)
CO292 STATISTICAL IDENTIFICATION AND STRUCTURAL VARS (Room BH (SE) 1.06)
CO032 RECENT ADVANCES IN APPLIED MACROECONOMICS (Room BH (SE) 2.05)
CO603 FINANCIAL ECONOMETRICS AND APPLICATIONS (Room BH (SE) 2.10)
CO657 RECENT METHODS FOR ANALYZING INFLATION (Room BH (SE) 2.12)
CC753 TIME SERIES I (Room BH (SE) 1.01)
CC784 EMPIRICAL FINANCE (Room BH (SE) 1.02)
CC801 ASSET ALLOCATION (Room BH (SE) 1.05)

Parallel Session L – CFE-CMStatistics

Monday 19.12.2022

08:40 - 09:55

EO178 STATISTICAL METHODS FOR COMPLEX DATA (Room S-1.01)
EO416 NEW PERSPECTIVES ON OLD QUESTIONS IN SURVIVAL ANALYSIS (Room S-1.22)
EO370 NONCLASSICAL EXTREME VALUE ANALYSIS (Room K0.20)
EO602 ADVANCES IN TIME SERIES AND SPATIO-TEMPORAL DATA (Room S0.03)
EO320 TEXT MINING FOR SOCIAL IMPACT (Room S0.11)
EO726 STATISTICAL MODELING AND MACHINE LEARNING WITH APPLICATIONS IN DATA SCIENCE (Room S0.12)
EO286 TOPICS IN MULTIVARIATE MODELLING AND HIGH DIMENSION (Room S0.13)
EO482 ADVANCES IN BAYESIAN COMPUTATION TECHNIQUES II (Room Safra Lecture Theatre)

EO543 NEW CHALLENGES IN DESIGN OF EXPERIMENTS II (Room Virtual R02)
 EO258 IDENTIFICATION AND EFFICIENT ESTIMATION IN CAUSAL INFERENCE (Room K2.31 (Nash Lec. Theatre))
 EO486 FUNCTIONAL TIME SERIES: THEORY AND APPLICATIONS (Room K2.40)
 EC828 MACHINE LEARNING II (Room S-1.04)
 EC820 GRAPHICAL MODELS (Room K0.16)
 EC679 BAYESIAN STATISTICS II (Room BH (S) 2.05)
 EC826 STATISTIC FOR COVID (Room K2.41)
 CV779 APPLIED ECONOMETRICS (Room Virtual R01)
 CO692 RECENT ADVANCES IN FINANCIAL ECONOMETRICS (Room Virtual R03)
 CO224 MACHINE LEARNING: NEW DEVELOPMENTS (Room Virtual R04)
 CO102 THE ECONOMETRICS OF BANKING AND FINANCE (Room Virtual R05)
 CO561 USING LARGE DATASETS TO ANALYSE HOUSEHOLD FINANCE (Room BH (SE) 1.02)
 CO126 BAYESIAN TIME SERIES ANALYSIS (Room BH (SE) 1.05)
 CO316 ADVANCES IN MACROECONOMETRIC MODELLING (Room BH (SE) 2.10)
 CC797 MACHINE LEARNING IN FINANCE (Room S-1.06)
 CC796 VALUE-AT-RISK (Room BH (SE) 1.01)
 CC794 MACROECONOMETRICS II (Room BH (SE) 1.06)
 CC768 TIME SERIES AND DYNAMIC MODELS (Room BH (S) 2.03)
 CC802 CRYPTOCURRENCY MARKETS (Room BH (SE) 2.05)
 CC804 YIELD CURVE (Room BH (SE) 2.09)

Parallel Session M – CFE-CMStatistics

Monday 19.12.2022

10:25 - 12:05

EO522 STATISTICAL METHODS FOR DEPENDENCE (Room S-1.04)
 EO304 MULTIVARIATE ANALYSIS OF COMPLEX DATA (Room S-1.06)
 EO048 INNOVATIONS IN LATENT VARIABLE MODELLING (Room S-1.27)
 EO402 RECENT ADVANCEMENTS IN STATISTICAL NETWORK ANALYSIS (Room K0.16)
 EO609 MODERN CAUSAL METHODS FOR CLINICAL AND HEALTH POLICY RESEARCH (Room K0.18)
 EO152 DIGITAL HEALTH AND INDIVIDUALIZED TREATMENT REGIMENS. (Room K0.19)
 EO640 SCALABLE INFERENCE METHODS FOR COMPLEX PROBLEMS (Room K0.20)
 EO456 HIGH-DIMENSIONAL LEARNING INFERENCE FOR DATA SCIENCE (Room K0.50)
 EO663 TIME SERIES AND SPATIAL STATISTICS: METHODOLOGY AND APPLICATIONS (Room S0.03)
 EO448 STATISTICS AND COMPUTING FOR STOCHASTIC PROCESSES (Room S0.11)
 EO577 BERNSTEIN-VON MISES THEOREM: RECENT RESULTS (Room S0.12)
 EO540 STATISTICAL SUMMITS: METHODOLOGY AND COMPUTING II (Room S0.13)
 EO118 NOVEL PERSPECTIVES IN BAYESIAN STATISTICS (Room Safra Lecture Theatre)
 EO246 STATISTICAL ANALYSIS FOR STOCHASTIC DIFFERENTIAL EQUATIONS (Room Virtual R02)
 EO676 STATISTICS OF EXTREMES (Room Virtual R03)
 EO240 DIRECTIONAL STATISTICS (Room Virtual R04)
 EO170 ADVANCES IN HETEROGENEOUS AND IMAGING DATA ANALYSIS (Room K2.31 (Nash Lec. Theatre))
 EO256 ADVANCES IN FUNCTIONAL AND OBJECT DATA ANALYSIS (Room K2.40)
 EO070 RECENT ADVANCES IN ANALYTICAL METHODS FOR LARGE-SCALE DATA (Room K2.41)
 CI023 ALTERNATIVE DATA IN FINANCE (Room BH (SE) 2.12)
 CO330 MIXED-FREQUENCY METHODS IN FINANCE AND ECONOMICS (Room S-1.01)
 CO090 ADVANCES IN BAYESIAN COMPUTATIONAL METHODS (Room Virtual R01)
 CO724 PANEL DATA (Room BH (SE) 1.01)
 CO699 VOLATILITY AND OPTION PRICING MODELS (Room BH (SE) 1.02)
 CO700 ALTERNATIVE DATA FOR ECONOMIC FORECASTING (Room BH (SE) 1.05)
 CO650 TIME SERIES: FORECASTING, NONLINEARITY AND MIXED FREQUENCY DATA (Room BH (SE) 1.06)
 CO661 ADVANCED STATISTICAL TOOLS IN SUSTAINABLE INSURANCE AND FINANCE (Room BH (SE) 2.05)
 CO346 FINANCIAL ECONOMETRICS: MODELLING AND FORECASTING (Room BH (SE) 2.10)

Parallel Session P – CFE-CMStatistics

Monday 19.12.2022

14:40 - 16:20

EO689 ECONOMETRICS: NEW DIRECTIONS (Room S-2.23)
 EO184 MACHINE LEARNING IN THE BEHAVIORAL SCIENCES (Room S-1.04)
 EO492 RECENT ADVANCES IN REINFORCEMENT LEARNING (VIRTUAL) (Room S-1.06)
 EO673 COMPLEX JOINT AND MULTIVARIATE MODELS WITH MEDICAL APPLICATIONS (Room S-1.27)
 EO562 NETWORK AND HIGH DIMENSIONAL DATA ANALYSIS (Room K0.16)
 EO066 RECENT ADVANCES IN BAYESIAN CAUSAL INFERENCE (Room K0.18)
 EO706 RECENT ADVANCES IN CAUSAL INFERENCE (Room K0.19)
 EO674 MULTIVARIATE METHODS: JOINT DIAGONALIZATION AND PROJECTION PURSUIT (Room K0.20)
 EO652 DESIGN AND ANALYSIS OF COMPLEX EXPERIMENTS: THEORY AND APPLICATIONS (Room K0.50)
 EO715 RECENT ADVANCES IN SPATIAL AND SPATIO-TEMPORAL STATISTICS (VIRTUAL) (Room S0.03)
 EO544 RANDOM MATRICES IN STATISTICS AND ECONOMETRICS (VIRTUAL) (Room S0.11)
 EO044 STATISTICS IN NEUROSCIENCE I (Room S0.12)
 EO711 DYNAMIC RANDOM OBJECTS (Room S0.13)
 EO514 ANALYSIS OF MULTILAYER NETWORKS (Room Virtual R01)
 EO360 ADVANCES IN MULTIVARIATE DATA ANALYSIS AND DIMENSION REDUCTION (Room Virtual R02)
 EO721 ADVANCES IN MARKOV CHAIN MONTE CARLO (Room Virtual R03)
 EO440 STATISTICAL MODELING, DESIGN, AND INFERENCE (Room Virtual R04)
 EO717 OPTIMAL TRANSPORT: RECENT THEORETICAL ADVANCES (Room Virtual R05)
 EO739 ADVANCES IN STATISTICAL METHODS FOR COMPLEX GENETIC/GENOMIC DATA (Room Virtual R06)
 EO556 OPPORTUNITIES AND CHALLENGES OF NEUROIMAGING DATA (Room Virtual R07)
 EO555 ADVANCES IN NONPARAMETRIC STATISTICS FOR LARGE-SCALE DATASET (Room Virtual R08)
 EO643 SAFE & TRUSTWORTHY PREDICTIVE MODELING (Room K2.31 (Nash Lec. Theatre))
 EO583 RECENT DEVELOPMENTS ON FUNCTIONAL DATA ANALYSIS (VIRTUAL) (Room K2.40)
 CO644 MACHINE LEARNING IN FINANCE (Room S-2.25)
 CO675 ASSET PRICING (Room S-1.01)
 CO462 ADVANCES IN ECONOMETRICS (Room S-1.22)
 CO478 NOVEL APPROACHES TO TIME SERIES FORECASTING (Room Safra Lecture Theatre)
 CO298 TOPICS IN TIME SERIES ECONOMETRICS (Room K2.41)

Parallel Session Q – CFE-CMStatistics

Monday 19.12.2022

16:50 - 18:30

EO667 FLEXIBLE BAYESIAN MODELLING FOR BIostatISTICS (Room S-2.25)
 EO635 RECENT ADVANCES IN HIGH-DIMENSIONAL INFERENCE (Room S-1.04)
 EO516 ADVANCES IN SEMIPARAMETRIC ESTIMATION AND FINANCIAL DATA ANALYSIS (Room S-1.06)
 EO591 ADVANCES IN ECOLOGICAL STATISTICS (Room S-1.22)
 EO114 ADVANCES IN LONGITUDINAL DATA ANALYSIS (Room S-1.27)
 EO160 NOVEL APPROACHES ON MODELING AND INFERENCE OF NETWORK DATA (Room K0.16)
 EO684 CAUSAL INFERENCE AND MACHINE LEARNING (Room K0.18)
 EO590 ADVANCES IN DESIGN-BASED CAUSAL INFERENCE (Room K0.19)
 EO338 ADVANCES IN ANALYZING AND MODELING COMPLEX HIGH DIMENSIONAL DATA (Room K0.20)
 EO040 HIGHLIGHTS OF CONTEMPORARY RESULTS IN DESIGN OF EXPERIMENTS (Room K0.50)
 EO418 SPATIO(-)TEMPORAL MODELING FOR BIOMEDICAL AND ENVIRONMENTAL DATA (Room S0.03)
 EO328 NONPARAMETRIC HIGH-DIMENSIONAL STATISTICAL LEARNING (Room S0.11)

EO046 STATISTICS IN NEUROSCIENCE II (Room S0.12)
EO210 MODERN STATISTICAL METHODS WITH APPLICATIONS TO COMPLEX DATA ANALYSIS (Room S0.13)
EO659 RECENT ADVANCEMENTS IN CAUSAL INFERENCE (Room Safra Lecture Theatre)
EO604 RECENT ADVANCES IN HIGH DIMENSIONAL TIME SERIES ANALYSIS (Room Virtual R01)
EO200 RECENT ADVANCES IN TAILORED DECISION MAKING (Room Virtual R02)
EO294 RECENT ADVANCES IN STATISTICAL METHODS FOR BIOMEDICAL DATA INTEGRATION (Room Virtual R04)
EO559 RECENT ADVANCES IN STATISTICAL LEARNING (Room Virtual R05)
EO565 RECENT DEVELOPMENTS FOR MULTIVARIATE ANALYSIS IN HIGH DIMENSIONS (Room Virtual R06)
EO608 STATISTICAL METHODS FOR MODERN BUSINESS APPLICATIONS (Room Virtual R07)
EO729 RECENT ADVANCES IN CAUSAL INFERENCE (Room Virtual R08)
EO164 EFFECT ESTIMATION UN VARIOUS CONTEXTS (Room K2.31 (Nash Lec. Theatre))
EO064 ADVANCES FOR FUNCTIONAL AND HIGH-DIMENSIONAL DATA ANALYSIS (VIRTUAL) (Room K2.40)
EO344 RECENT ADVANCES IN STATISTICAL MODELING OF COMPLEX DATA STRUCTURES (Room K2.41)
EC823 COMPUTATIONAL STATISTICS II (Room S-1.01)
CO198 MACROECONOMIC POLICY (Room S-2.23)
CO290 RECENT ADVANCES IN FORECASTING (Room Virtual R03)